

Keyed Removable Mullion Installation Instructions

Not for use with Fire Rated Exit Devices

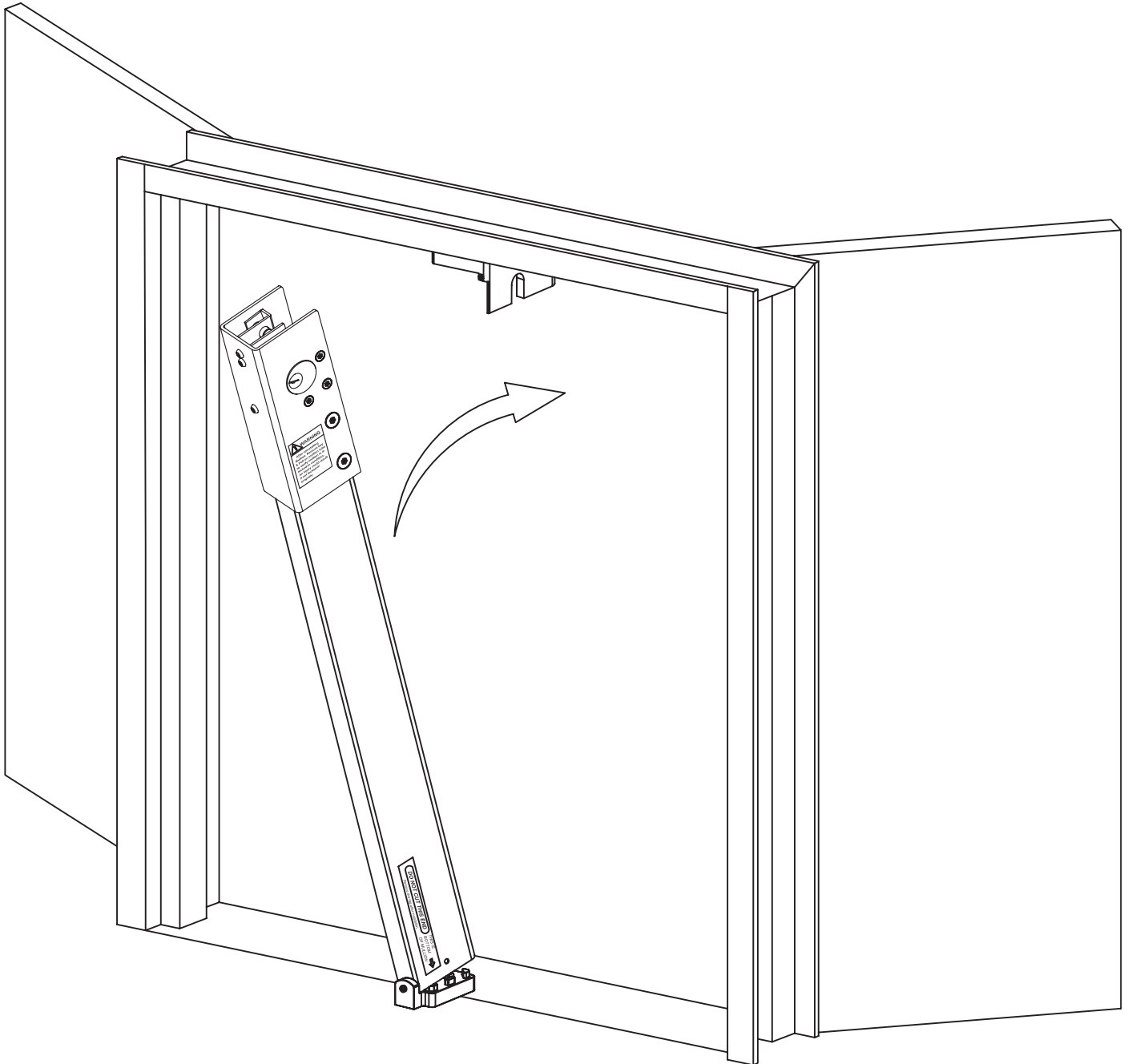

This kit includes the following parts : (Not to scale)

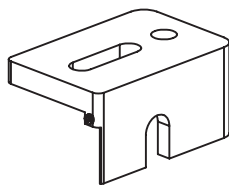

Top Retainer

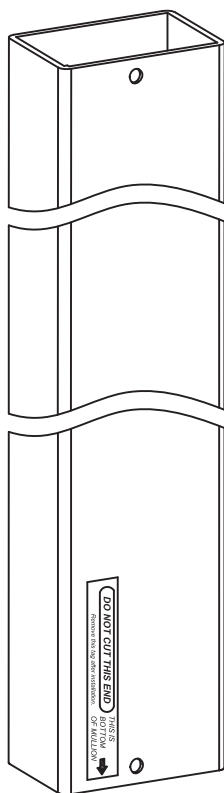

Mullion Tube



Adjustment Shim



5/32" Allen Wrench

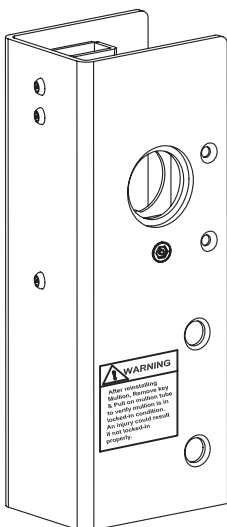

Headcap Chassis Assembly

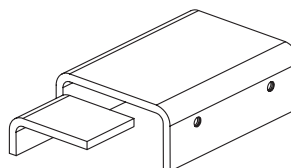

Back Plate

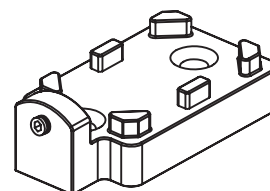

Bottom Retainer



Cylinder Retaining Nut

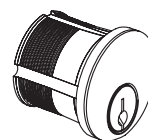

Mortise Cylinder

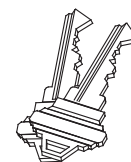

Two Keys

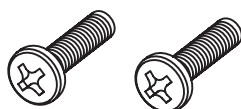

5/16-18 x 1-1/4"
(2 PCS)
Phillips Pan Head
Machine Screw



8-32 x 1/4"
(4 PCS)
Undercut Flat Head
Socket Security
Machine Screw

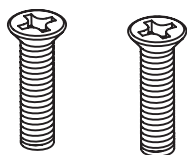

5/16-18 x 1-1/4"
(2 PCS)
Flat Pan Head
Machine Screw

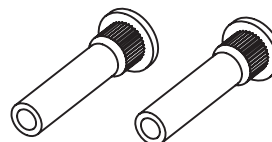

Thru Bolts
(2 PCS)

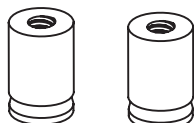

Expansion Anchor
(2 PCS)



1/4 -20 x1"
(2 PCS)
Flat Head
Socket Security
Machine Screw

Step 1 Prepare the Keyed Headcap Chassis Assembly.

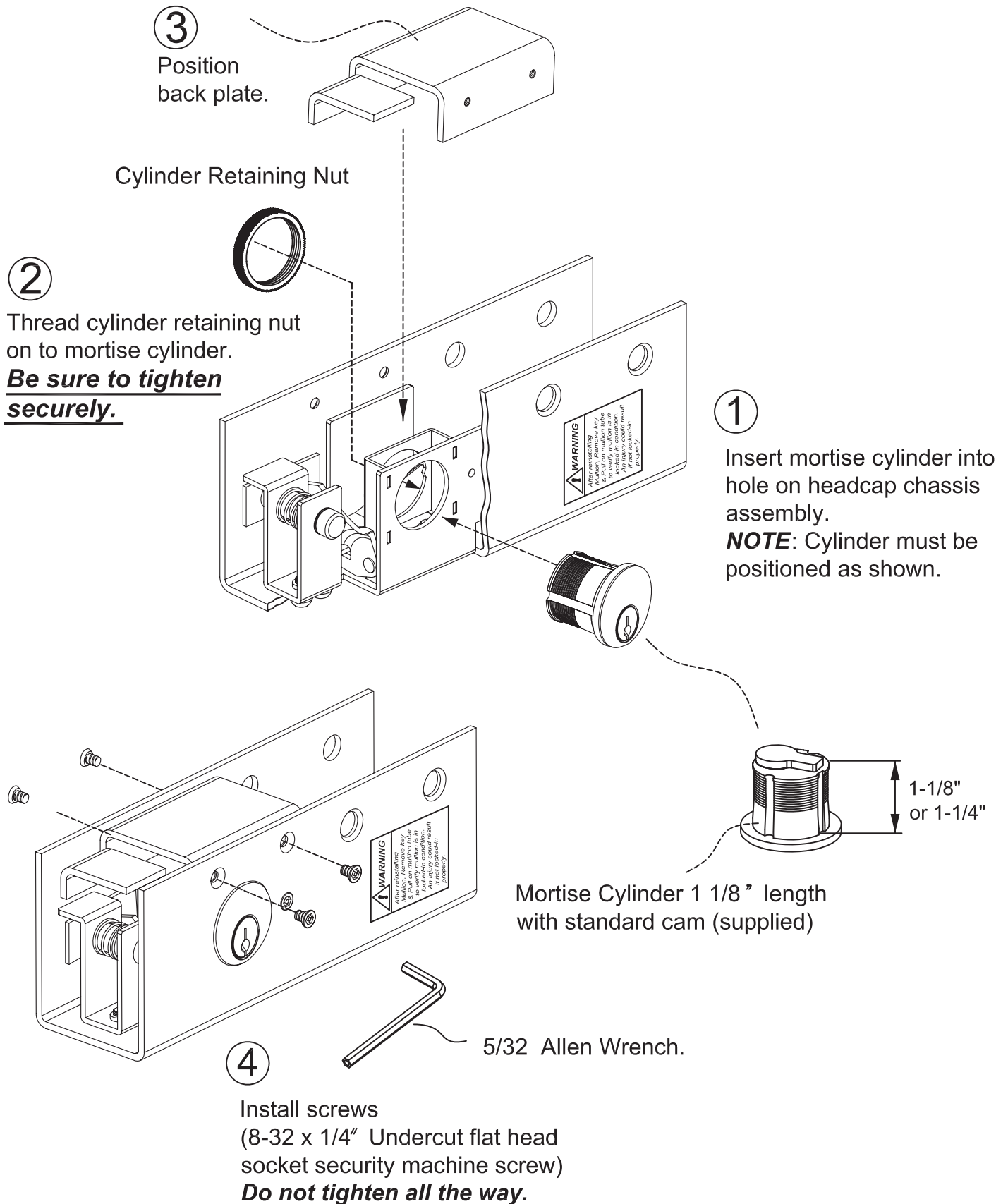

Not to scale 1:1. Measurements are for reference only. Not a drilling template.

Step 2 Install Bottom Retainer

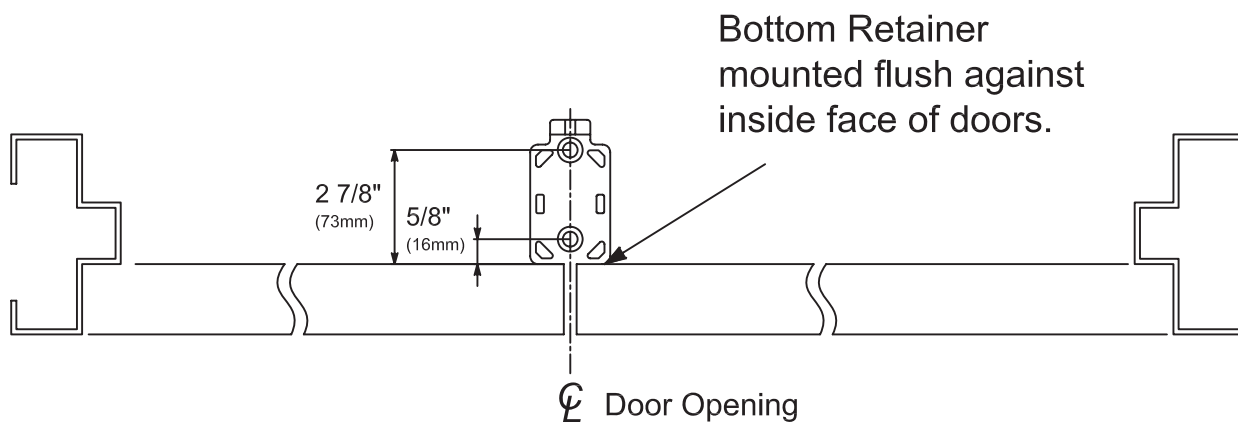
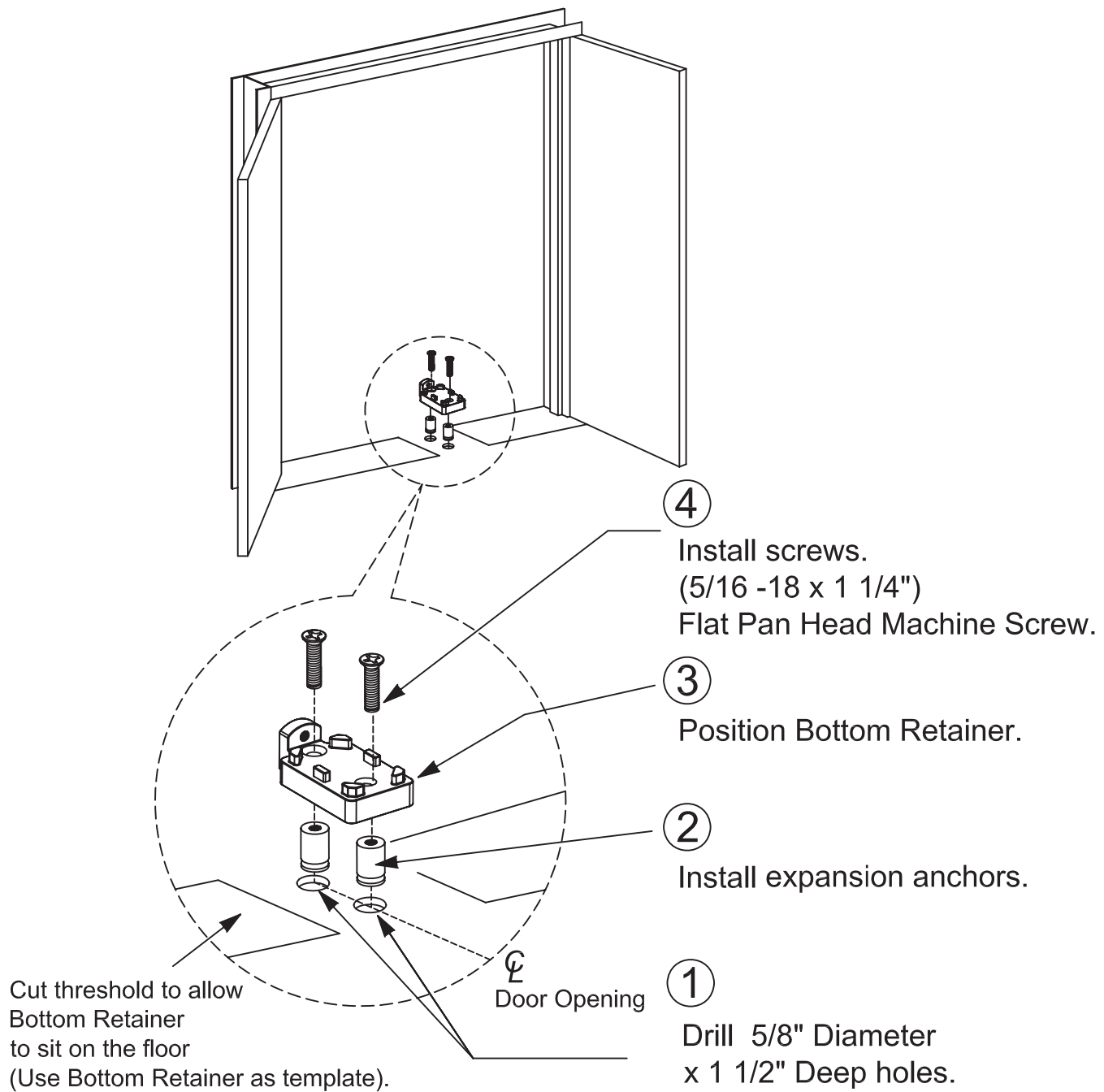

Not to scale 1:1. Measurements are for reference only. Not a drilling template.

Step 3 Size mullion

Measure from
this edge.

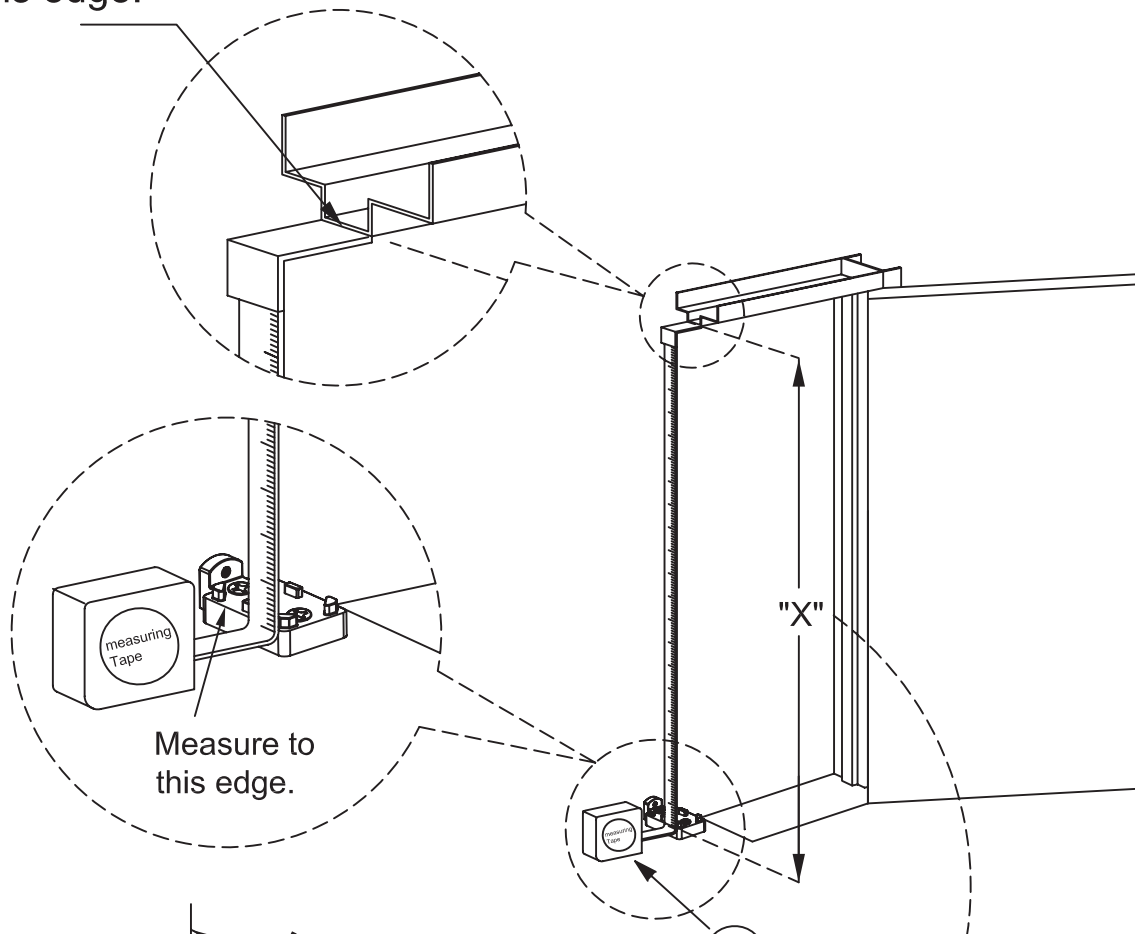

Do not cut end of mullion
with warning label.

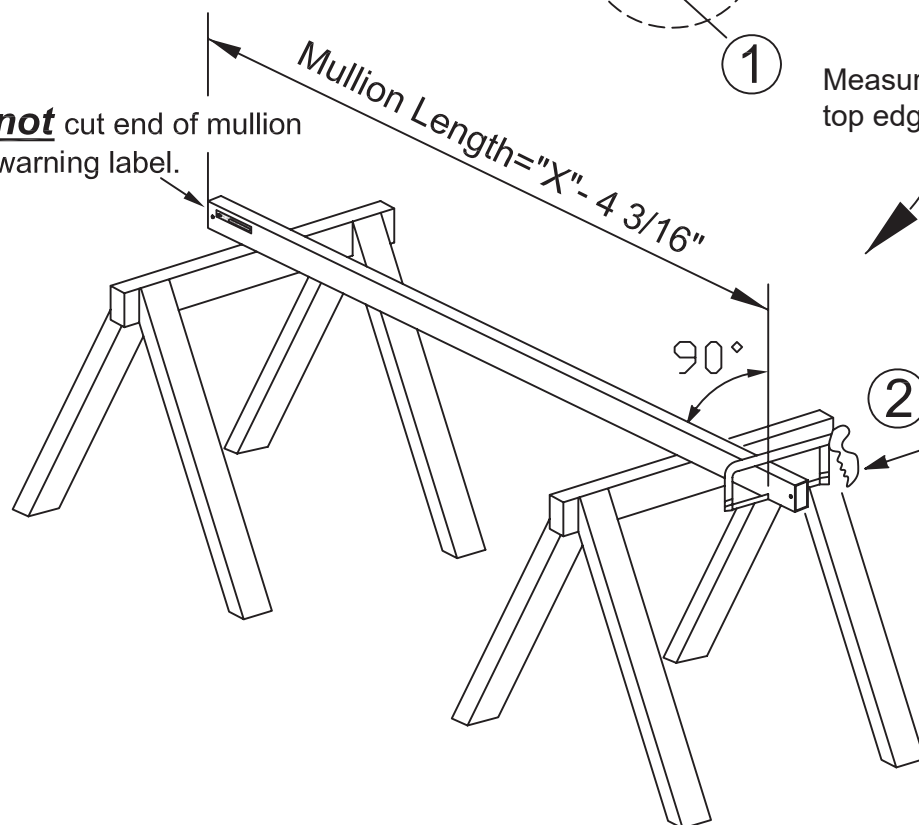

Measure distance from frame to the
top edge of the Bottom Retainer.

Determine mullion length
using formula and cut.
Remove all burrs and
sharp edges.

Step 4 Install Top Retainer.

Adjustment Shim — Note: If mullion is cut between 3/16" - 5/16" too short, add top mullion fitting shim.

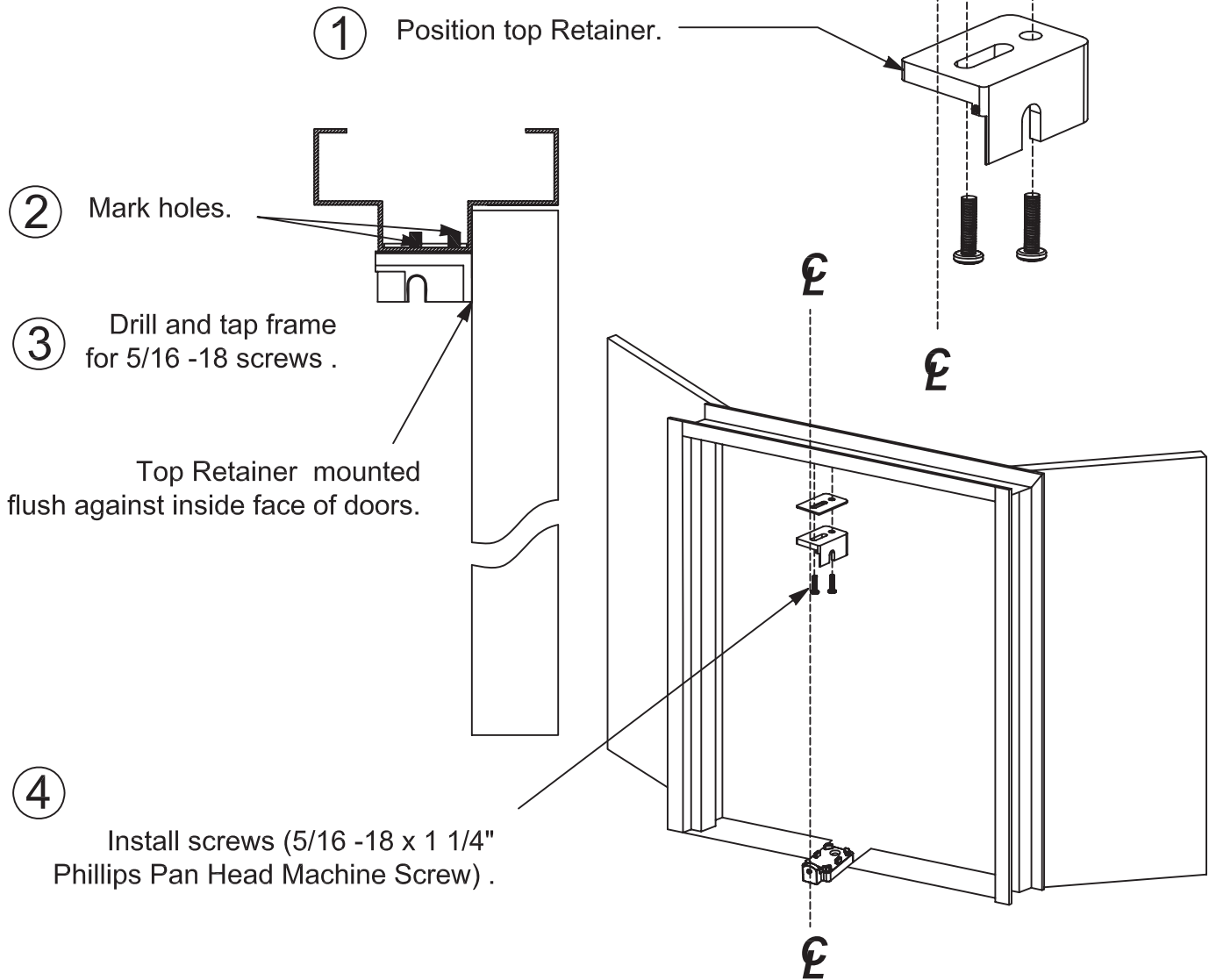

Optional frame styles for mounting top retainer:

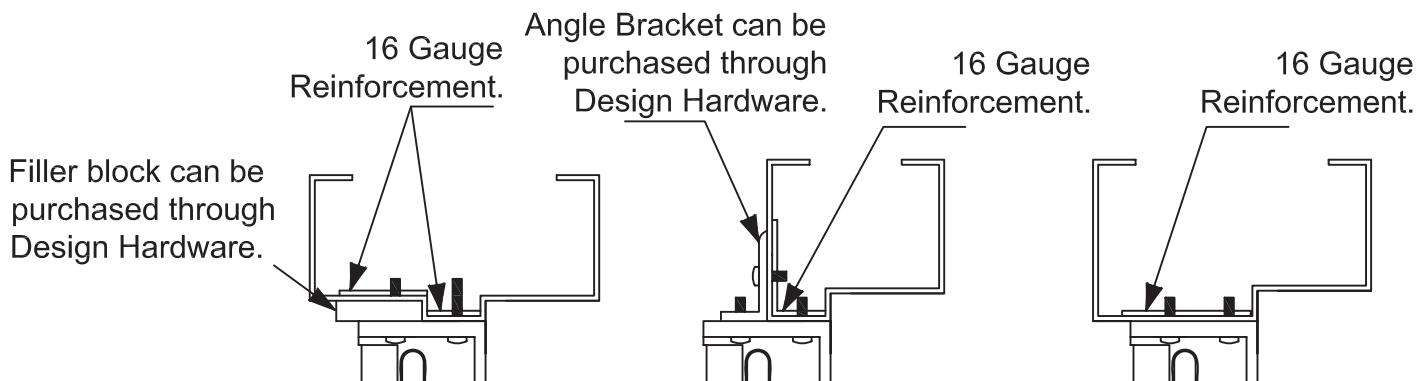

Note: 16 Gauge Reinforcements must be supplied by frame manufacturer.

Step 5 Attach headcap chassis assembly to mullion

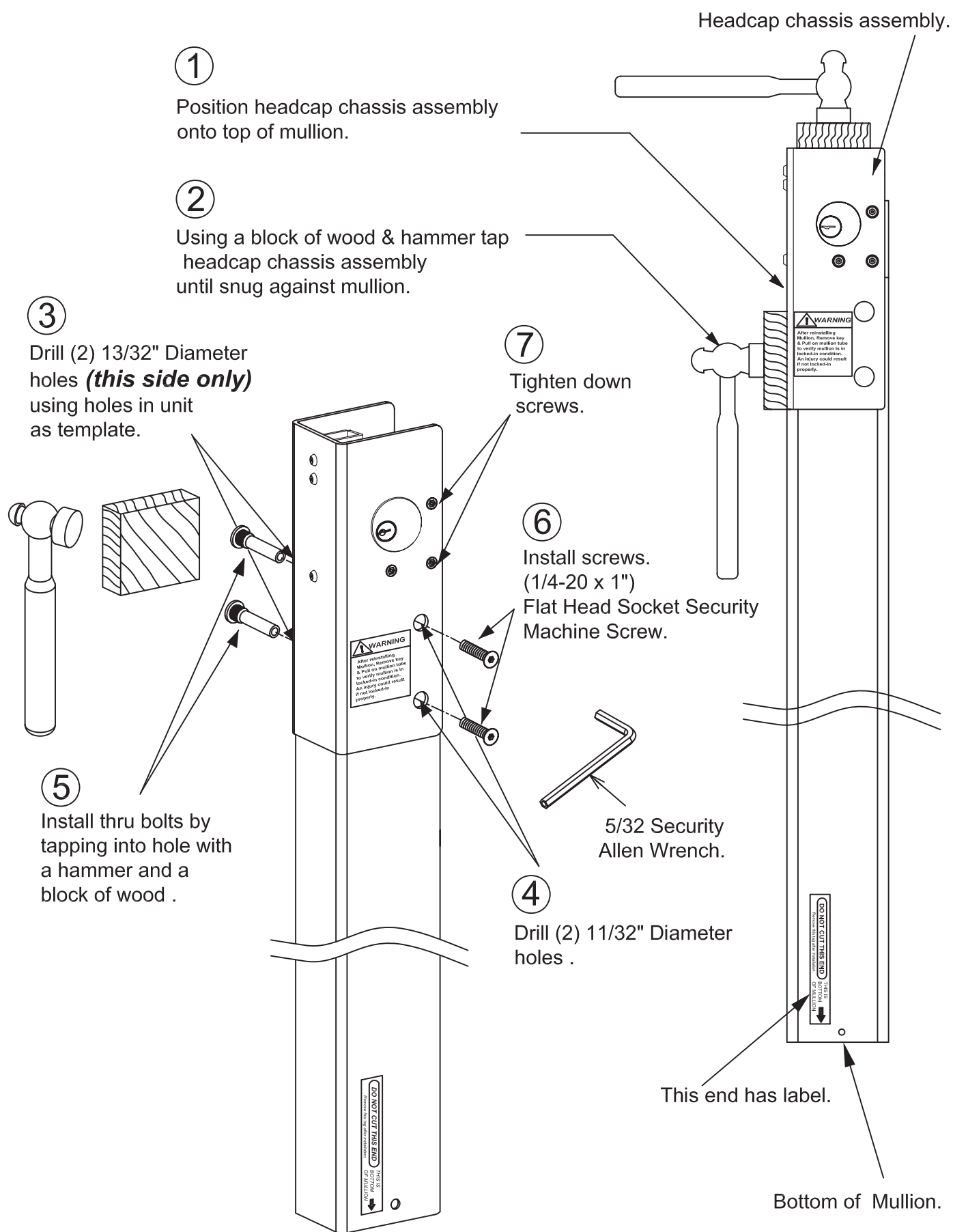

Step 6 Final installation & Adjustment

1

Install screw
(8-32 x 3/8" set screw)
until flush with face of
Top Retainer
Install mullion.

2

Check for tightness of mullion by pushing
and /or pulling on mullion.
To tighten,remove mullion (see Step 7)
and rotate set screw out 1/2 turn.
Repeat this procedure until desired tightness is
reached.

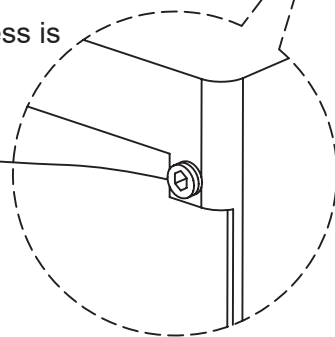
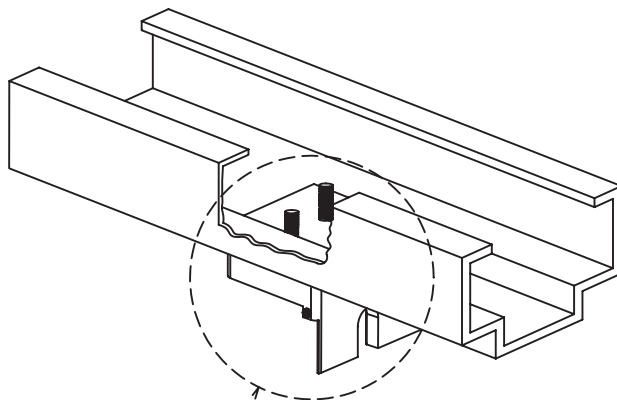

WARNING !

**If set screw is adjusted out
too far,the bolt may not latch
completely allowing the mullion
to fall out when impacted.**

Step 7 Operation

Rotate key 180°
clockwise to unlock
and remove mullion.

