

Z-Series Heavy Duty Lock

Installation Instructions for Standard Cylinder

● Leverset is set for 1 3/4" thick door - Backset 2 3/4"

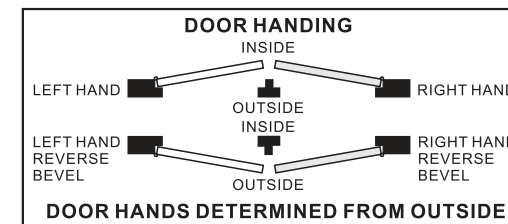
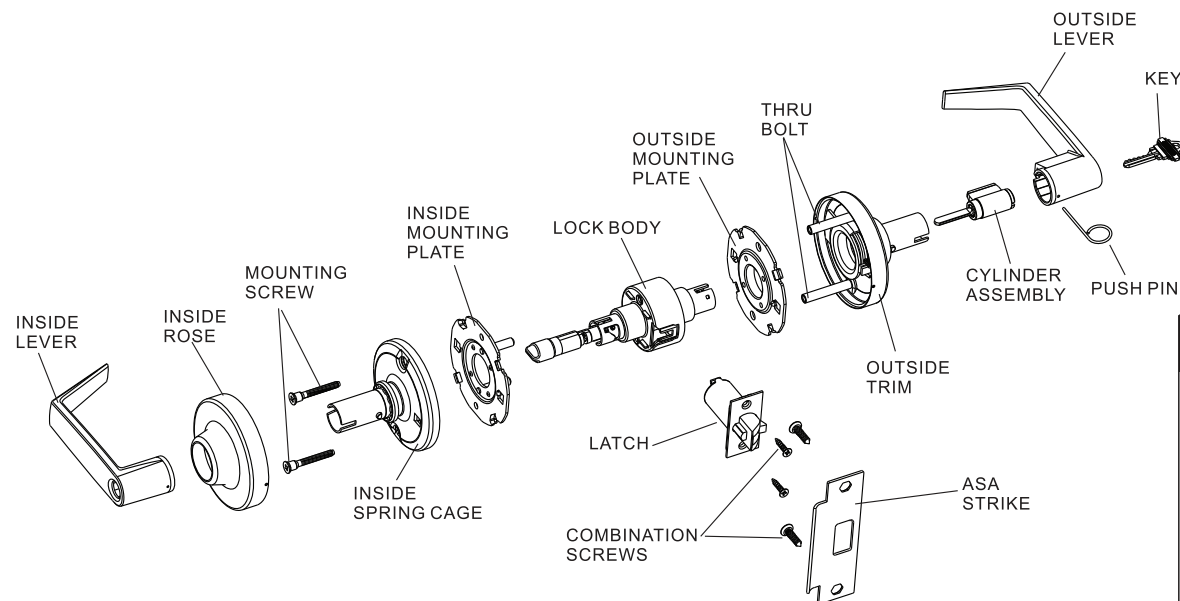

Install Latch

Prepare door per template.
Insert latch and secure
with combination screws.

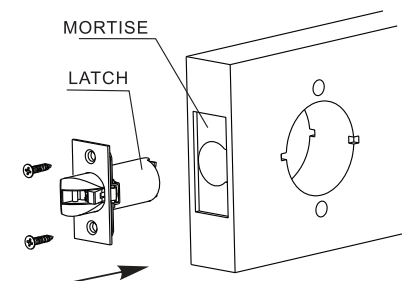

1 DISASSEMBLE INSIDE LEVER AND ROSE

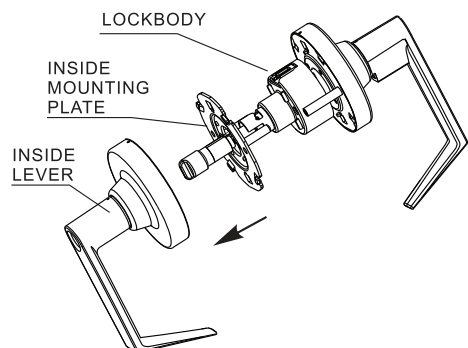

1A: Remove inside rose chassis and inside mounting plate from the lock body.

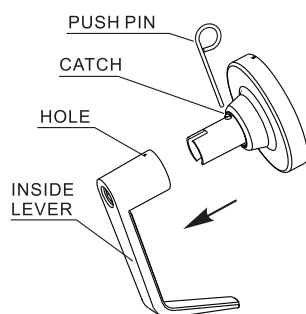

1B: Insert push pin into hole in inside lever to depress catch then remove inside lever.

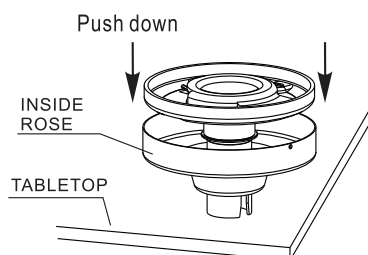

1C: Remove the inside rose from inside rose chassis.

2 INSTALL LEVERSET ONTO DOOR

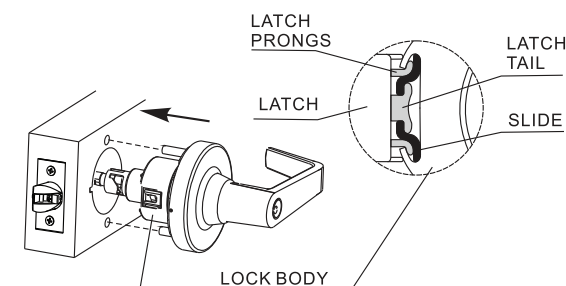

2A: Place lock body into position. Make sure that latch prongs engage chassis housing, and slide engages latch tail.

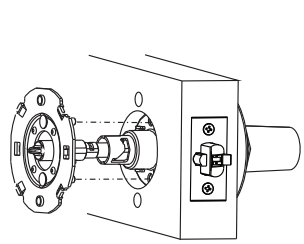

2B: Install inside mounting plate.

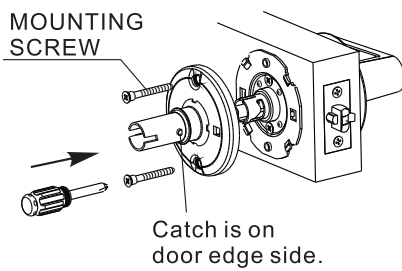

2C: Install inside spring cage and secure with two mounting screws.

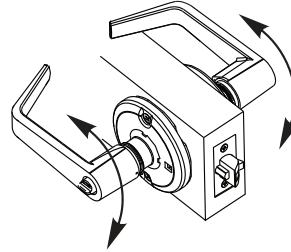

2D: Slide inside lever onto spindle but do not lock it into place and check to see if the rotation is smooth. Adjust mounting screw if necessary.

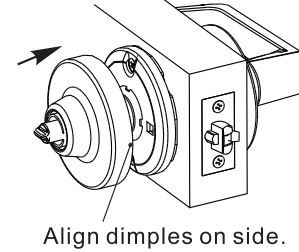

2E: Remove inside lever and install inside rose, make sure inside rose is fully snapped in.

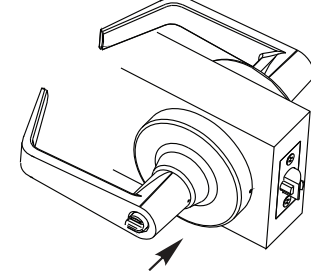

2F: Slide inside lever onto spindle. Push lever completely onto spindle until it locks into place. (Pull on lever to make sure that catch is fully engaged.)

3 INSTALL STRIKE

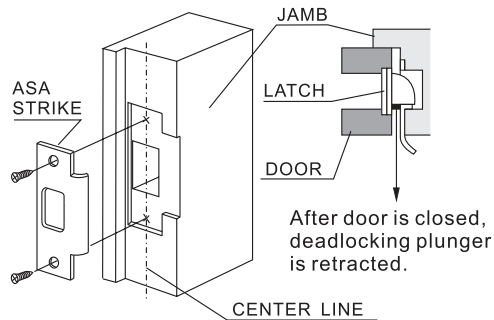

INSTRUCTIONS FOR ADJUSTING LOCK TO FIT DOOR THICKNESS OTHER THAN 1-3/4"

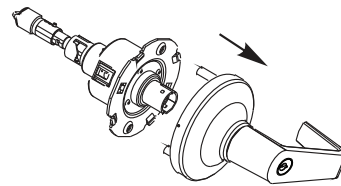

A: Pull off outside rose assembly.

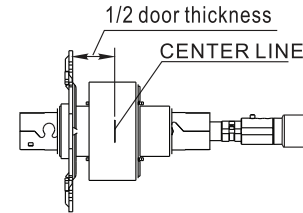

B: Turn outside mounting plate to adjust center line of lock body to match the centerline of the door.

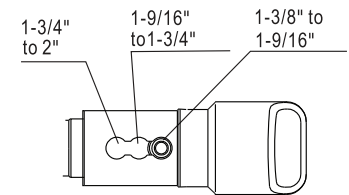

C: Adjust push button to the required position. The lock is factory preset for 1-3/4"

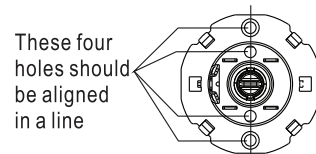

D: Align four holes in line when finish adjusting door thickness.

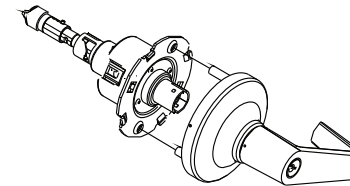

E: Reinstall outside trim onto lock body for next installing.

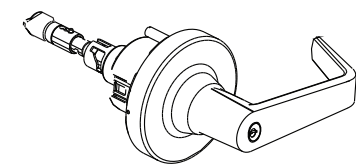

F: Insert key to check key function and make sure lock function is correct.

INSTRUCTIONS FOR CYLINDER REPLACEMENT

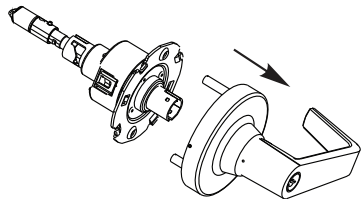

A: Pull off outside rose assembly.

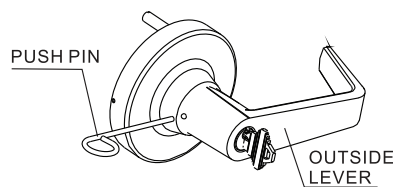

B: Turn key 90 degrees, Insert push pin into hole in outside lever to depress catch.

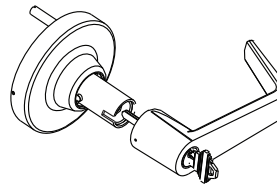

C: Remove old cylinder. Install a new cylinder, turn key 90 degrees, then put in outside lever onto spindle.

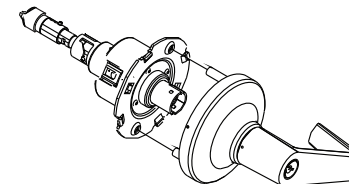

D: Pull out key, then install outside trim onto lock body for next installing.

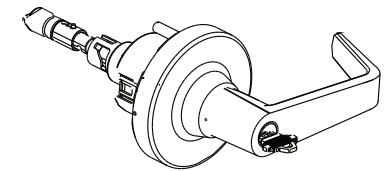

E: Insert key to check key function and make sure lock function is correct.

Not to scale 1:1. Measurements are for reference only. Not a drilling template.

Always consult dormakaba's website for the latest instructions at designhardware.net or call 1-800-392-5209.

Design Hardware is a trademark of dormakaba USA Inc. ©2021 All rights reserved.